

3126800155

N Plug Crimp For LMR240

50Ω

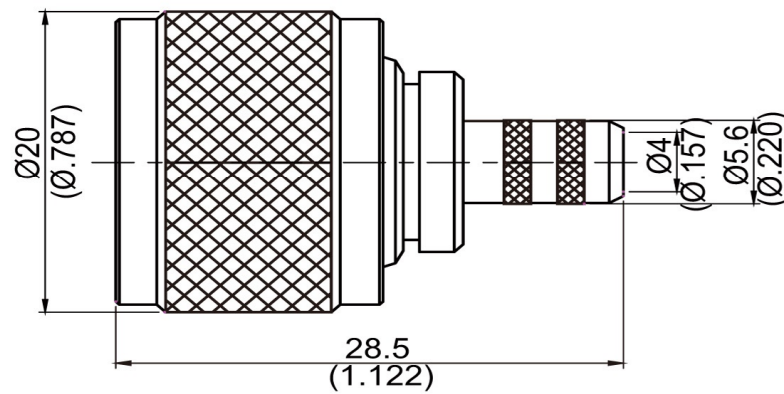

Parts	Material	Plating (Micro-inch)
Ferrule	Copper	Tin-Zinc-Copper-Alloy 100 Over Copper 50
Gasket	Silicon	
Contact Pin	Brass	Gold 4 Over Nickel Phosphorous Alloy 80 Over Copper 20
Insulator	Teflon	
Body	Brass	Tin-Zinc-Copper-Alloy 100 Over Copper 50
Coupling Nut	Brass	Tin-Zinc-Copper-Alloy 100 Over Copper 50

Suitable Cables: LMR240

This part number complies with RoHS.

3126800155

#### Interface

MIL-STD-348B

#### Electrical Data

Impedance	50Ω
Frequency range	DC to 6GHz
VSWR	$\leq 1.2$ (DC to 6GHz)
Insertion loss	$\leq 0.05 \times \sqrt{f(\text{GHz})}$ dB
Insulation resistance	$\geq 5000\text{M}\Omega$
Contact resistance inner conductor	$\leq 1.5\text{m}\Omega$
Contact resistance outer conductor	$\leq 1\text{m}\Omega$
Dielectric withstanding voltage (at sea level)	2500 V rms
Working voltage (at sea level)	1000 V rms

#### Mechanical Data

Recommended coupling nut torque	6 to 10 inch lbs
Coupling proof torque	15 inch lbs
Coupling nut retention force	$\geq 101.2$ lbs
Contact captivation-axial	$\geq 6.3$ lbs
Durability (mating)	$\geq 500$

#### Environmental Data



Temperature range	-65°C to +165°C
Thermal shock	MIL-STD-202, Method 107, Condition B
Moisture resistance	MIL-STD-202, Method 106
Corrosion	MIL-STD-202, Method 101, Condition B
RoHS	Compliant

#### Tooling

Crimping tool  
Crimp insert

Notice:

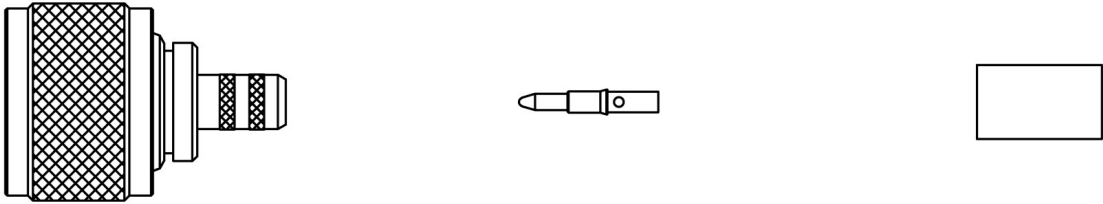
# CABLE ASSEMBLY RECOMMENDATION

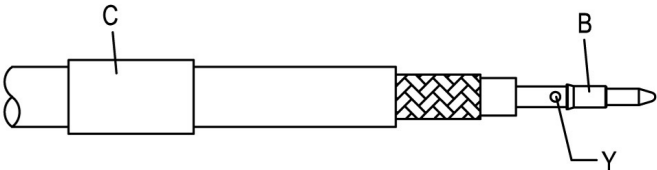
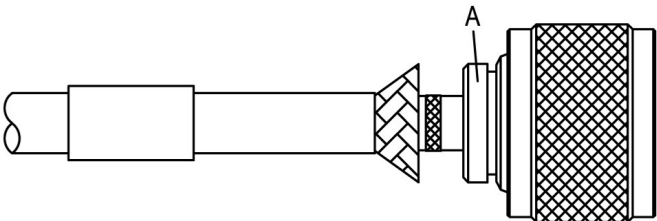
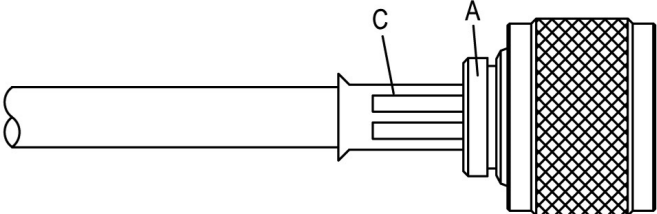
3126800155		DATE	2018/09/20	REV	A
<div><div>A</div><div>B</div><div>C</div><div></div><div>BODYCONTACT PINFERRULE</div></div>					
DIAGRAM			ASSEMBLY INSTRUCTION		
			Step 1: STRIP AS SHOWN.		
			Step 2: SLIDE FERRULE " C " OVER CABLE. Step 3: PUT PIN " B " ON CENTER CONDUCTOR AND SOLDER OR CRIMP IN " Y ". (USE SQUARE 1.6mm/0.063inch SECTION OF INSERT-E IF CRIMPED)		
			Step 4: LOOSEN BRAIDING AND SLIDE CONNECTOR " A " IN PLACE.		
			Step 5: SLIDE FERRULE " C " TOWARDS THE CONNECTOR " A " AND CRIMP. (USE 6.5mm/0.256inch HEX SECTION OF INSERT-E)		

This part number complies with RoHS.  
Notice:

APPROVED	CHECKED	DRAWING
----------	---------	---------