

3120700322

BNC Plug Crimp For Mini coax

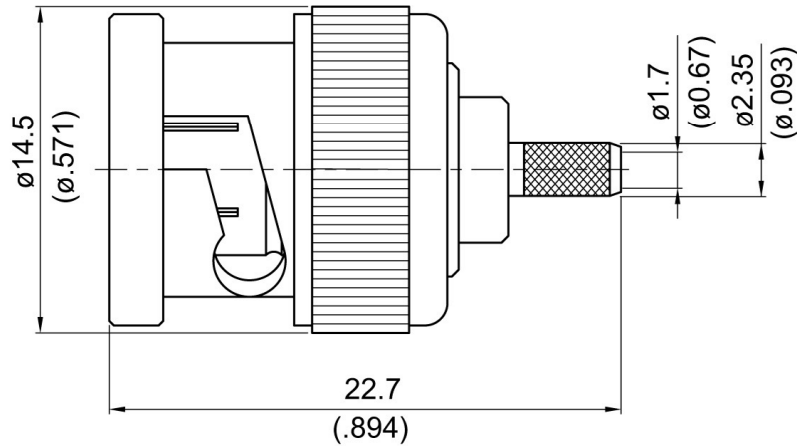

| Parts | Material | Plating (Micro-inch) |
|--------------|----------|--------------------------------------------------------|
| Ferrule | Brass | Tin-Zinc-Copper-Alloy 100 Over Copper 50 |
| Contact Pin | Brass | Gold 4 Over Nickel Phosphorous Alloy 80 Over Copper 20 |
| Gasket | Silicone | |
| Washer | Brass | Tin-Zinc-Copper-Alloy 100 Over Copper 50 |
| Spring | SK5 | Tin-Zinc-Copper-Alloy 100 Over Copper 50 |
| Insulator | Teflon | |
| Body | Brass | Tin-Zinc-Copper-Alloy 100 Over Copper 50 |
| Coupling Nut | Brass | Tin-Zinc-Copper-Alloy 100 Over Copper 50 |

Weight: 7.9g

Suitable Cables: **Mini coax**

This part number complies with RoHS.

Notice:

3120700322

Interface

MIL-STD-348B

Electrical Data

| | |
|------------------------------------------------|-------------------------------------------|
| Impedance | 75 Ω |
| Frequency range | DC to 3GHz |
| VSWR | ≤ 1.2 (DC to 3GHz) |
| Insertion loss | $\leq 0.1 \times \sqrt{f(\text{GHz})}$ dB |
| Insulation resistance | $\geq 5000\text{M}\Omega$ |
| Contact resistance inner conductor | $\leq 1.5\text{m}\Omega$ |
| Contact resistance outer conductor | $\leq 1\text{m}\Omega$ |
| Dielectric withstanding voltage (at sea level) | 1500 V rms |
| Working voltage (at sea level) | 500 V rms |

Mechanical Data

| | |
|---------------------------------|---------------------|
| Recommended coupling nut torque | 0.6 to 2.5 inch lbs |
| Coupling nut retention force | ≥ 101.2 lbs |
| Contact captivation-axial | ≥ 6.1 lbs |
| Durability (mating) | ≥ 500 |

Environmental Data

| | |
|---------------------|--------------------------------------|
| Temperature range | -65°C to +165°C |
| Thermal shock | MIL-STD-202, Method 107, Condition B |
| Moisture resistance | MIL-STD-202, Method 106 |
| Corrosion | MIL-STD-202, Method 101, Condition B |
| RoHS | Compliant |

Tooling

Crimping tool
Crimp insert

Notice:

CABLE ASSEMBLY INSTRUCTION

3120700322

DATE

2017/10/30

REV

—

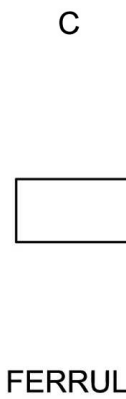
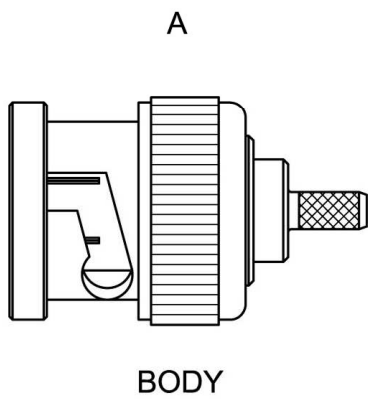

DIAGRAM

ASSEMBLY INSTRUCTION

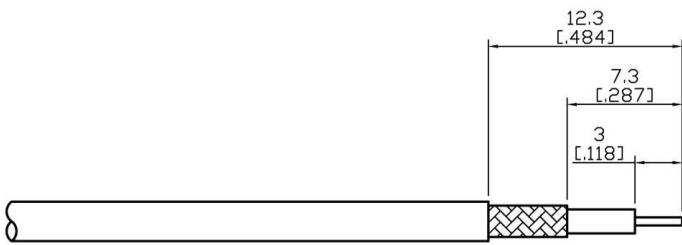

Step 1: STRIP AS SHOWN.

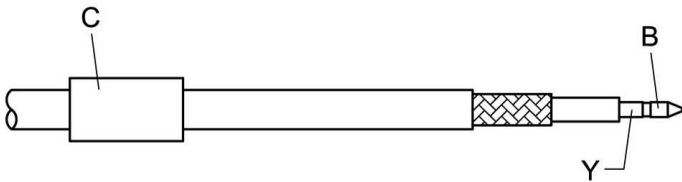

Step 2: SLIDE FERRULE " C " OVER CABLE.
 Step 3: PUT PIN " B " ON CENTER CONDUCTOR AND CRIMP IN " Y ".
 (USE SQUARE 0.7mm/0.028inch SECTION OF INSERT-A)

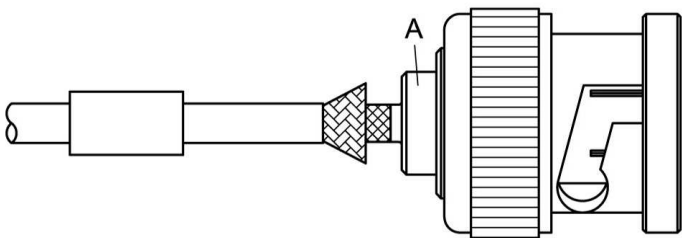

Step 4: LOOSEN BRAIDING AND SLIDE CONNECTOR " A " IN PLACE.

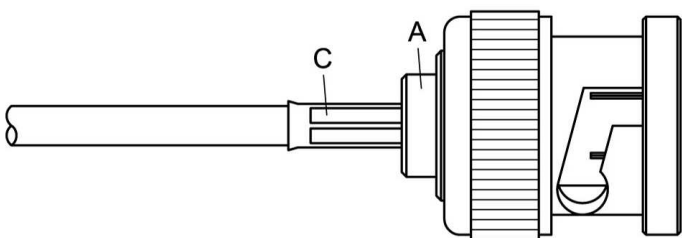

Step 5: SLIDE FERRULE " C " TOWARDS THE CONNECTOR " A " AND CRIMP.
 (USE 3.3mm/0.130inch HEX SECTION OF INSERT-A)

This part number complies with RoHS.

Notice:

APPROVED

CHECKED

DRAWING